

Advanced Networking Solutions

With an innovative modular design, the Sharp FO-DC Series allows you to get the functionality you need today—along with the expandability you'll need in the future.

As your needs change, you can easily add network scanning, network printing, web-based management tools, and advanced diagnostics software—for increased efficiency. Plus, Sharp's advanced software utilities integrate seamlessly with your existing network, adding even more functionality—and productivity—to your workflow.



ADVANCED WEB-BASED MANAGEMENT

The FO-DC Series Home Page offers many time saving tools, such as scan and fax destination management, E-mail status notifications, remote diagnostics, device configuration, and more. Designed for both end-users and administrators, the FO-DC Series Home Page is simple, yet sophisticated, and provides password protection at the administrator level. (Requires FO-LN1.)

INTEGRATED NETWORK SCANNING

With its flexible suite of document management tools, the Sharp FO-DC Series network scanning option provides three scanning functions that deliver exceptional efficiency—Scan to Desktop, Scan to E-mail, and Scan to FTP.



Scan to Desktop allows you to send scanned files directly to your desktop and store them in your favorite file formats. Sharpdesk™ complements this feature by enabling you to easily manage these files.



Scan to E-mail saves time and allows you to send scanned images directly to any e-mail address.



Scan to FTP enables you to scan to any File Transfer Protocol (FTP) site or server that allows uploading. Easily store and access files no matter where you are.

Finally, with Sharpdesk document management software with Composer, users have a comprehensive easy-to-use tool that allows them to view, distribute, integrate, and manipulate documents regardless of the applications used to create them. (Requires FO-LN1 and FO-NS2.)

EFFICIENT NETWORK PRINTING

With the optional network printing expansion kit, the FO-DC Series also becomes a 16-ppm network laser printer that outputs a crisp 600 dpi resolution. Additionally, PCL6/PCL XL page description language ensures that your printed documents are processed quickly, with the superior quality you've come to expect. (Requires FO-LN1 and FO-NP1.)

PRINTER ADMINISTRATION UTILITY

Printer Administration Utility (PAU) is a network tool designed to speed up the installation and configuration of all connected Sharp devices. Primarily for network administrators, it allows you to manage all SNMP-compliant printers on the network, right from your desktop. (Standard with FO-NP1.)

PRINTER STATUS MONITOR

Printer Status Monitor is an application that enables users to view network printer conditions through an easy-to-use graphical interface. It even notifies you when your job is complete! (Standard with FO-NP1.)

REMOTE E-MAIL DIAGNOSTICS

Sharp's Remote E-mail Diagnostics (R.E.D.) enables users, administrators, or Sharp authorized service providers to automatically receive e-mail messages regarding specific notifications from the FO-DC Series. From basic maintenance, such as "add paper" or "low toner" to more complex needs, R.E.D. helps ensure that your FO-DC Series facsimile runs at peak performance. (Standard with FO-LN1.)

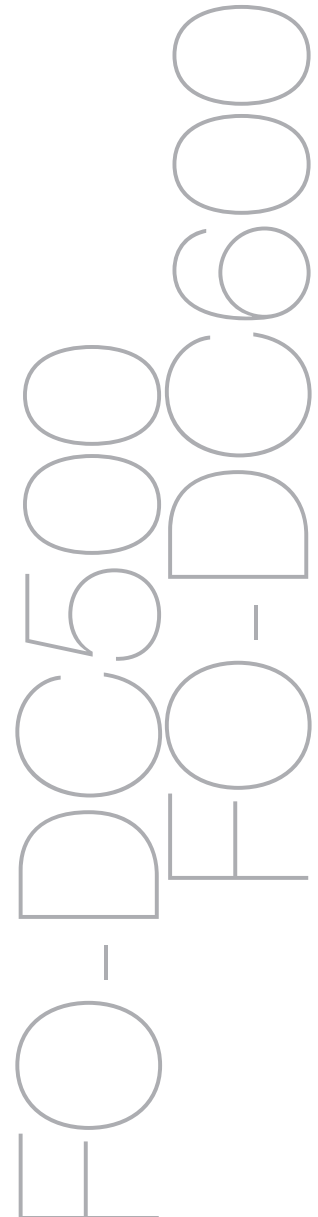
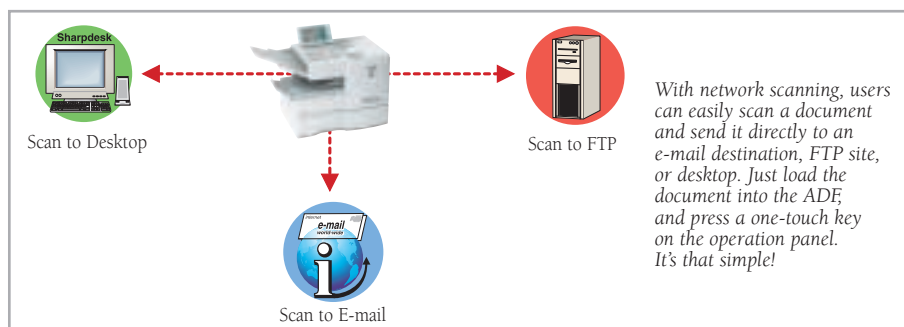

FO-DC500/DC600 DOCUMENT COMMUNICATION SYSTEMS

ADVANCED NETWORKING SOLUTIONS

LAN-BASED F.A.S.T. SYSTEM REMOTE MANAGEMENT

With Sharp's LAN-Based F.A.S.T. (Facsimile Automated Service Technology) Remote Diagnostics System, the FO-DC Series monitors vital machine statistics, such as fax operation, printing, paper handling, and supply usage. Should there be any abnormalities, the FO-DC Series can contact the F.A.S.T. system at your dealership over the Internet to report the condition. Your dealer can also contact your machine over the Internet to see precisely what the problem is, as well as upload new firmware, make software adjustments, and change auto-dial numbers for you. (Requires FO-LN1.)

Sharp's dedication to providing a complete line of facsimile products for every business need has made us a leader in the industry since 1987. Our outstanding record as the No.1 fax company for thirteen out of the last fifteen years shows that our products offer superior performance, competitive features, and proven reliability. With a Sharp facsimile, you get more power, more features, and more productivity. No wonder Sharp facsimiles are the best selling in history.

SHARP
THE BEST SELLING
FACSIMILES IN HISTORY

KEY FEATURES

FO-DC500

FO-DC600

Super G3	Yes	Yes
Document Memory Backup (Flash)	Yes	Yes
Duplex Scanning	Yes	Yes
400 dpi Send/Receive	Yes	Yes
One-Touch (Rapid) Dials	59	59
Abbreviated (Speed) Dials	100	200
Personal Auto-Dial Books	20	40
Tilting LCD Display	Yes	Yes
Dual Line Kit	—	Optional
Group Dialing	158 Locations	258 Locations
Polling	179 Locations	279 Locations
Serial Broadcasting	179 Locations	279 Locations
Program Keys	59	59
Confidential Send/Receive	10 Boxes	10 Boxes
Chain Dialing	Yes	Yes
Anti-Junk Fax	50 Locations	50 Locations
Department Codes	30	30
Telephone-Billing Codes	9 Digits	9 Digits
Distinctive Ring	Yes	Yes
Batch Transmission	59 Jobs	59 Jobs
Auto Reduction	Yes	Yes
Print Smoothing	Yes	Yes
Quick On-Line	Yes	Yes
Automatic Cover Sheet	Optional	Standard
Dual Access	Yes	Yes
Flash ROM Updates	Yes	Yes
Auto Cassette Switching	Optional	Standard
Fax Separator Page	Optional	Standard

OPTIONAL EXPANSION KITS AND SPECIFICATIONS

LAN Interface Expansion Kit FO-LN1 (optional)

Operating System:	Windows® 98/ME/2000/NT4/XP
Protocol:	TCP/IP
Type:	10/100 baseT
Requirements:	Ethernet LAN, Mail Server, FTP Server
Utilities/Software:	IP Peer to Peer Redirector Web page for configuration and maintenance

Network Printing Expansion Kit FO-NP1 (optional)*

Print Speed:	16 pages per minute
Print Resolution:	600 dpi
Printer Description Language:	PCL6/PCL XL
Fonts:	45 outline fonts
Memory:	16 MB/144 MB maximum
Utilities/Software:	Integrated installer, print drivers, Printer Status Monitor, and Printer Administration Utility

Network Scanner Expansion Kit FO-NS2 (optional)

Scan Resolution:	400 dpi (true optical)
Data Format:	PDF, TIFF
Protocol:	FTP, SMTP
Document Management Software:	Sharpdesk
OCR:	Included with Sharpdesk software
Scan to E-mail:	Standard
Scan to Desktop:	Standard
Scan to FTP:	Standard
Utilities/Software:	Sharpdesk, Network Scan Tool

* On FO-DC600, the FO-60DL Dual Line Kit cannot be installed in conjunction with FO-NP1 Network Printing Expansion Kit.

Design and specifications subject to change without notice.

Sharp is a registered trademark of Sharp Corporation. All other trademarks and registered trademarks are the property of their respective holders.



As an ENERGY STAR® Partner, SHARP has determined that this product meets the ENERGY STAR® guidelines for energy efficiency.



Sharp Electronics Corporation
Sharp Plaza, Mahwah, NJ 07430-1163
1-800-BE-SHARP
www.sharppusa.com

SHARP
be sharp™